

---

**SCHLETTER**  
*The Solar Mounting Group*

**DURABILITY  
BY SIMPLICITY**  
SCHLETTER  
TRACKING SYSTEM



---

## KEY FEATURES & BENEFITS

- 2 modules vertical or 4 modules horizontal
- highest ground cover ratio (>50 %)
- free passage between the tracker rows
- self-locking at any post in any position
- no galloping effects due to structural concept
- no dampers required
- self-powered system / wireless communication / no cabling for controller and motor
- easy installation due to pre-assembled components

### LARGEST MODULE AREA PER MOTOR

Up to 480 m<sup>2</sup> (4 x 120 m) module area per motor which enables the highest ground cover ratio (GCR) in the market.

### INDEPENDENT SELFLOCKING ROWS WITH 120 DEGREE ROTATIONAL RANGE

Each row has its unique and patented way of self-locking at any post in any position. The widespread danger of „galloping“ is fully avoided. That gives the necessary security to your investment. A wide rotational range of 120 ° delivers more energy during the entire day.

### SELF-POWERED CONTROL AND DRIVE SYSTEM WITH WIRELESS COMMUNICATION ARCHITECTURE

Each row is working self-powered. A dedicated PV panel provides the power for the controller and the motor. The battery backup system ensures safety and reliability to the entire system.

---

## SPECIFICATION

Tracking type	horizontal single axis self-powered tracker
Module configuration	2 in portrait or 4 in landscape (1000 or 1500 V DC)
Tracking range	120 ° (±60 °)
DC capacity / modules per tracker	approx. 80 kWp (depending on module type), max. 240 modules
Drive system	24 V DC motor, self-powered system (grid powered system possible on demand)
Length per tracker	120 m / 400 ft
Width per tracker	4 m / 13 ft
Height per tracker at 60°	4 m / 13 ft (with 0.5 m / 1.6 ft ground clearance)
Flood clearance	1.2 m / 4 ft clearance for electrical components
Ground coverage ratio (GCR)	>50 %
Tracking control system	astronomical
Stow position, night position	10 °



# STABLE AS A FIXED TILT

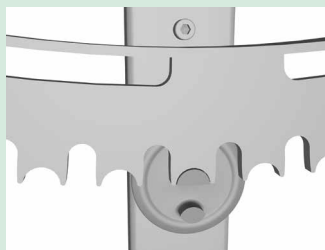

locking position

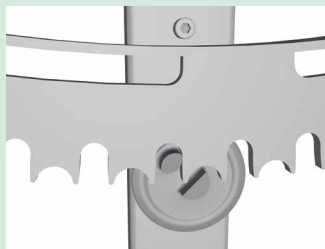

stepping position

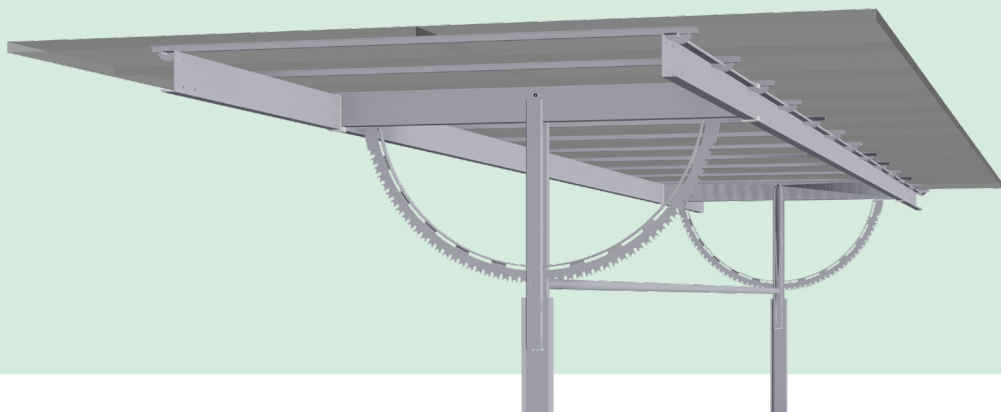

---

## SPECIFICATION

Backtracking	yes
Snow position	yes
Maintenance position	yes
Monitoring system	Network Control Unit / SCADA interface
Control system	wireless self-powered controller for each row / ZigBee communication
Compliance	UL 2703 / UL 3703 / ASCE 7-10 / CE 2006/42/EC / DIN EN 62817
Protection class	IP54 / IP65 / NEMA 4x
Material	galvanized steel / stainless steel
Corrosiveness category	standard C3, optional C4 or more
Operating temperature range	-25 °C to +60 °C / -13 °F to 140 °F
Foundation	C-Channel SRF7 / wide flange beam e.g. W6x7
Max. slope	N-S 10 °, E-W 10 °
Max. wind speed in tracking mode (standard)	up to 35 mph (3-sec.gust)
Max. wind speed in stow position (standard)	up to 105 mph (3-sec. gust)
Max. wind speed in stow position (optional)	up to 160 mph (3-sec. gust)
Warranty	10 years on structural components; 5 years on drive, battery and control systems. Extended terms available.



SCHLETTER GMBH (Headquarters)  
Alustraße 1  
83527 Kirchdorf  
GERMANY

[info@schletter-group.com](mailto:info@schletter-group.com)  
[www.schletter-group.com](http://www.schletter-group.com)

Subject to changes and/or technical modifications.